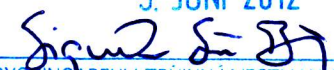
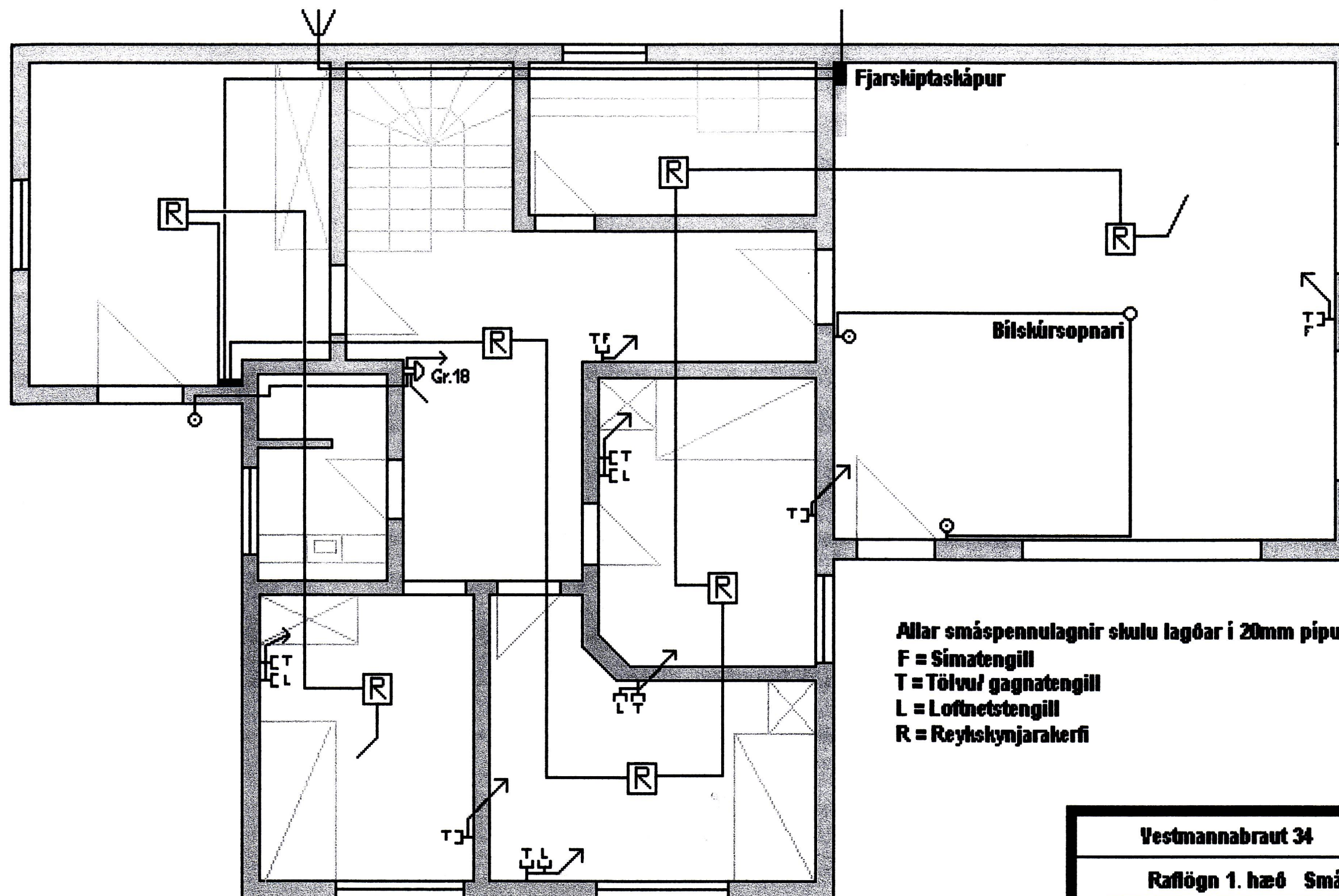

5. JÚNÍ 2012

 BYGGINGARFULLTRÚINN Í VESTMANNAEYJUM

Allar smáspennulagnir skulu lagðar í 20mm pípum

F = Símatengill

T = Tölvu/ gagnatengill

L = Loftnetsengill

R = Reykskynjarakerfi

Vestmannabraut 34 Fell

Raflögn 1. hæð Smáspenna

Hönnun / teiknun:

Hjálmar Brynjúlfsson Lögg.rafverktaki

Blað 3 af 5

Apríl 2012