

SKYRINGAR

- L1 2x11W PL
- L2 2x36W FLURPERUR
- L3 2x36W FLURPERUR
- L4 2x36W FLURPERUR
- UT PRIGGJA STUNDA UT/NEYÐARLJOS
- L5 2x11W PL
- L6 2x36W FLURPERUR
- L7 2x36W FLURPERUR
- L8 2x58W FLURPERUR
- L9 150W NATRIUMPERA
- L10 18W FLURPERA

- STRENGLISTI A STAL OG LIMTRESPERRUR 60mm
- STRENGSTIGI 300mm
- AL-TENGLARENNA TVISKIPT FYRIR LAG- OG SMASPENNU

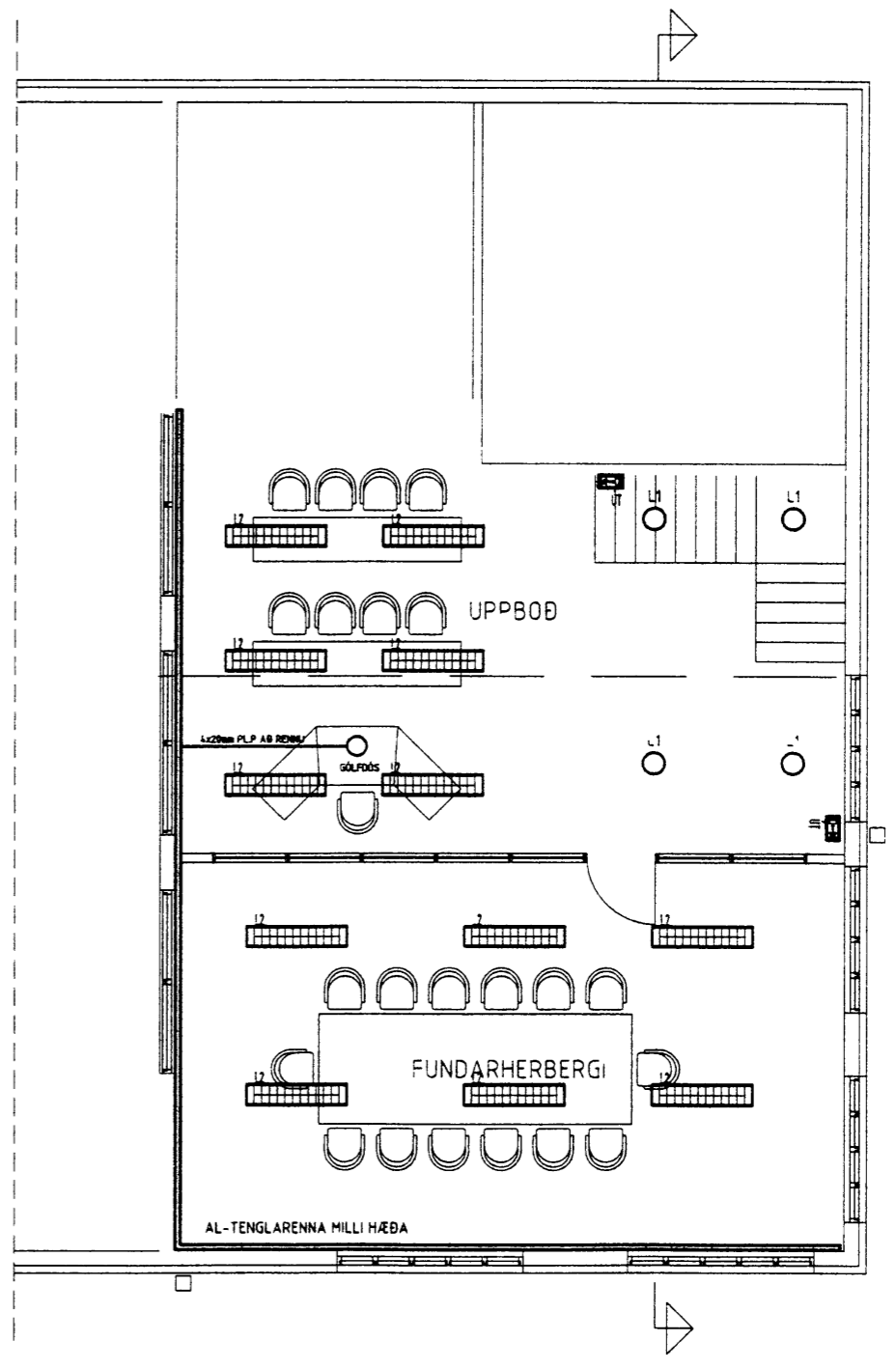
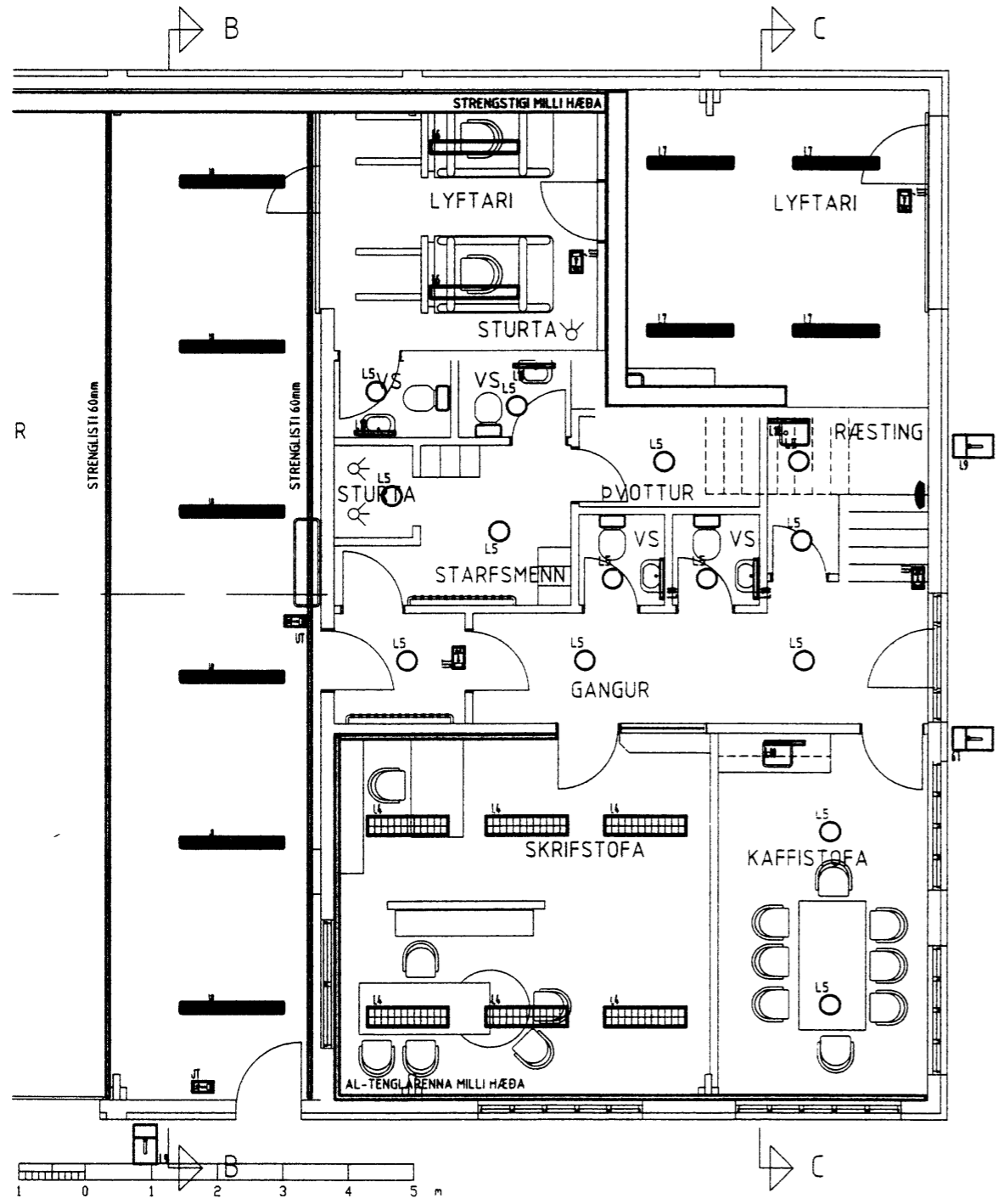

MAÐRÁÐ	DH
TEKNI	DH
YFIR	
SAÐR.	
VEÐUR	

RAFTENING HF  
RÁÐLAUFVORULEIÐINGAR



FISKMARKAÐUR VESTMANNAEYJA  
GRUNNMYND