

A 70/01 Grunnmynd, salerni Miðheimar 1:20

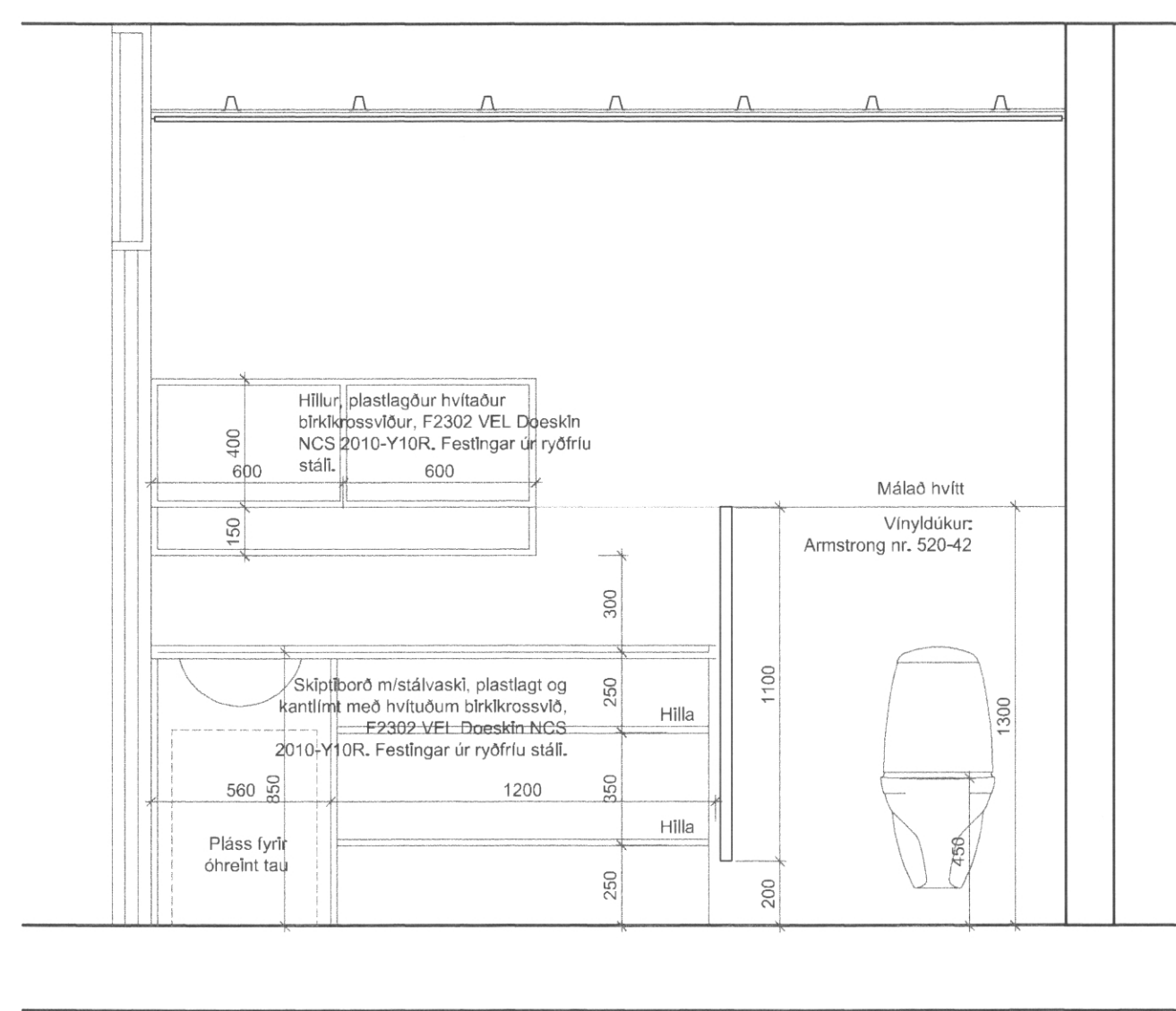

B 70/01 Sneiðing A - A, salerni 1:20

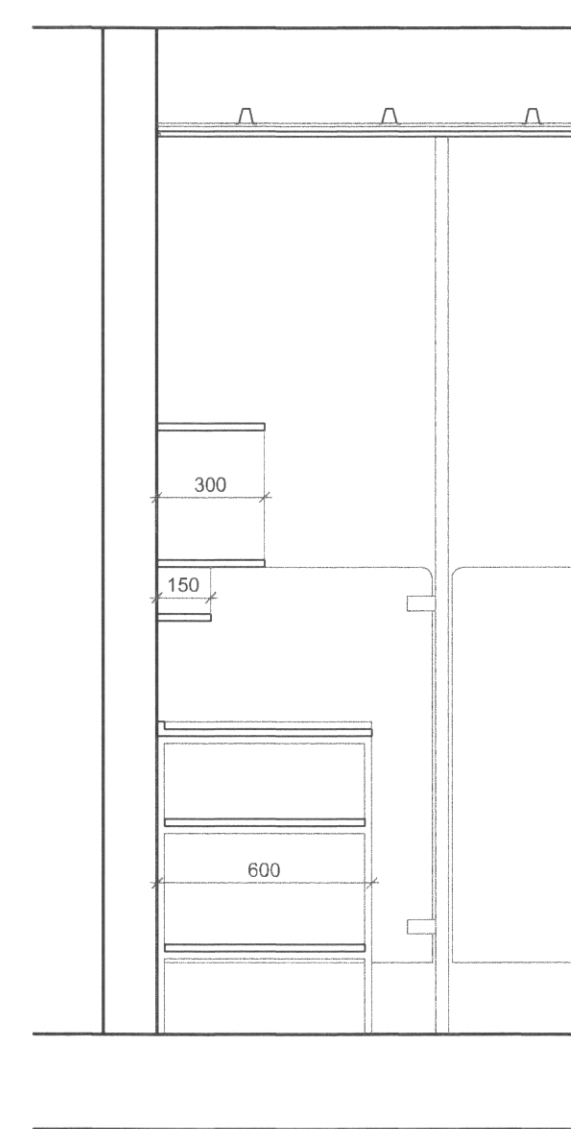

C 70/01 Sneiðing B - B, salerni 1:20

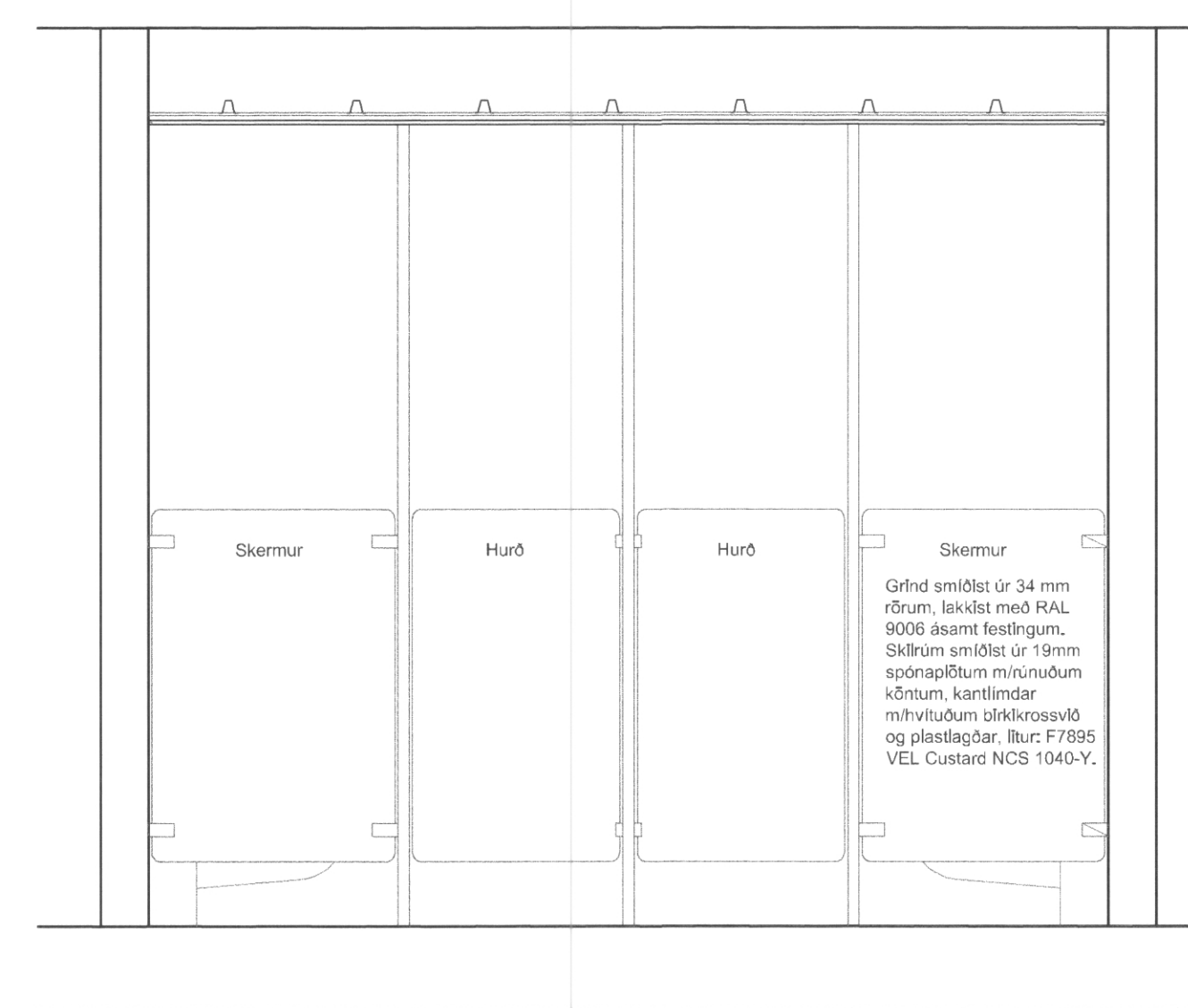

I 70/01 Sneiðing B - B, salerni 1:20

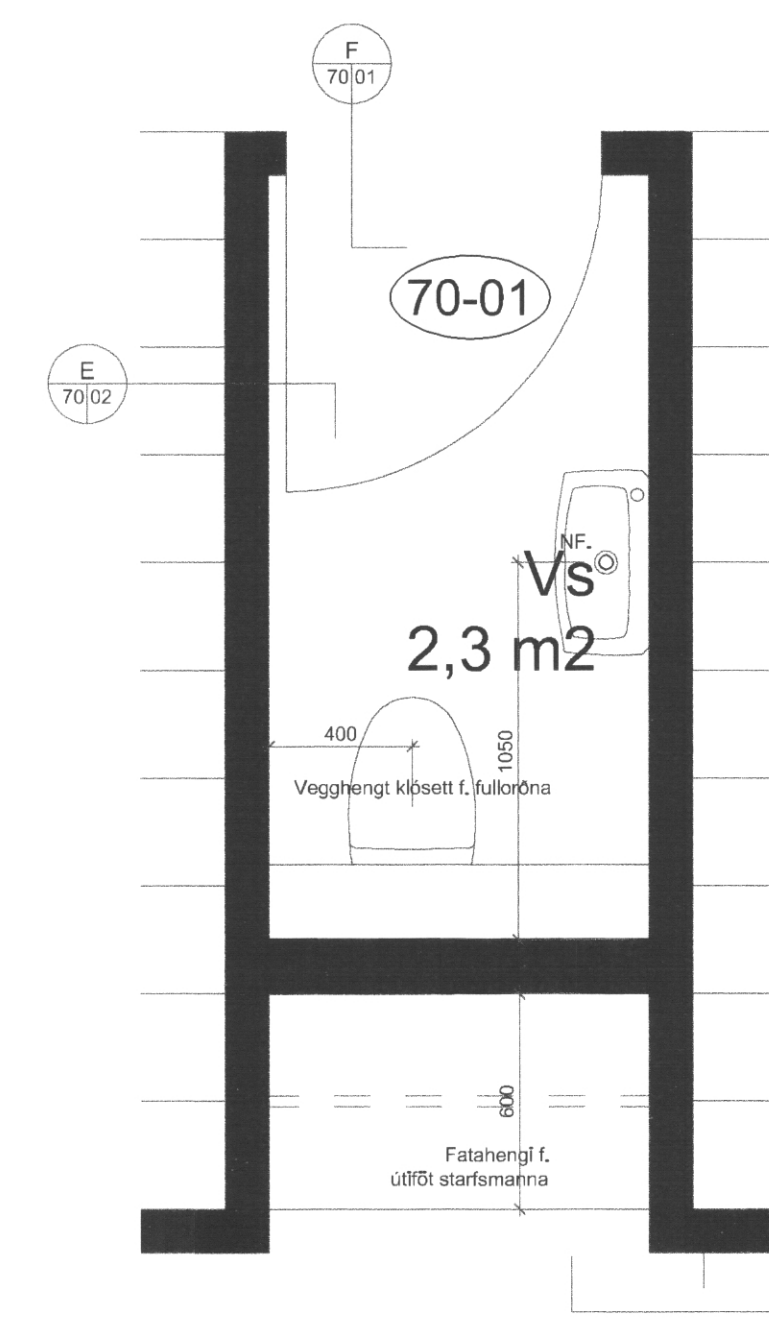

D 70/01 Grunnmynd, salerni 1:20

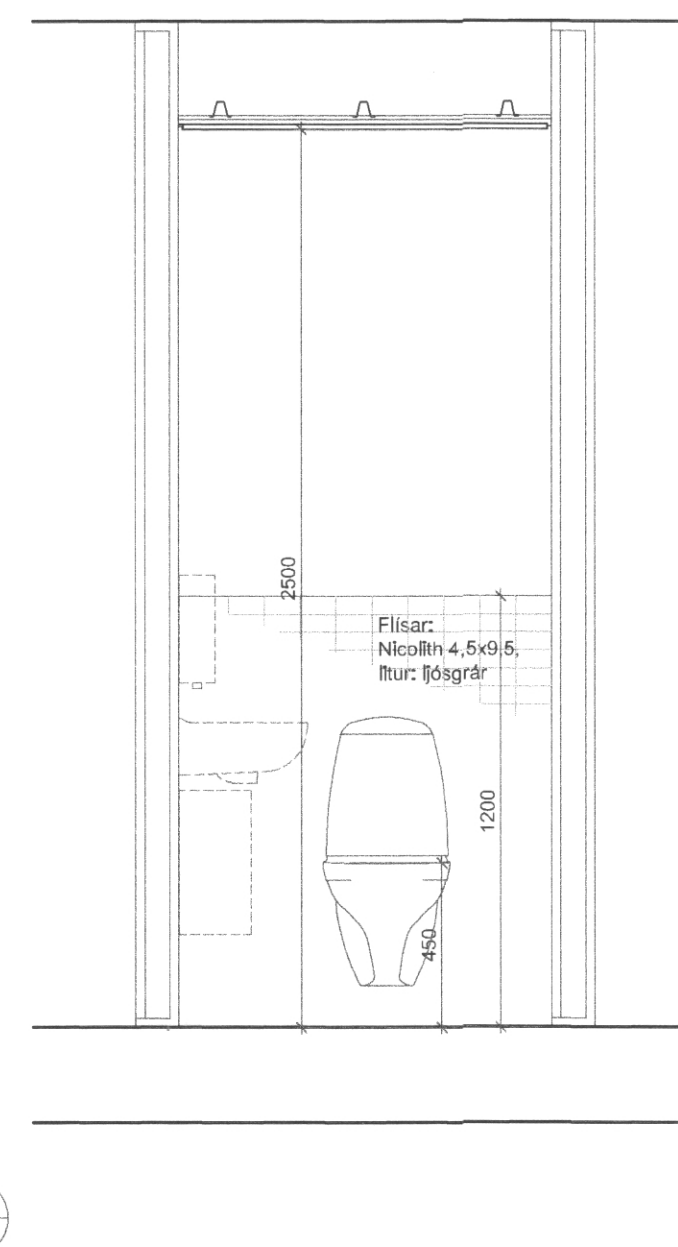

E 70/01 Sneiðing A - A, salerni 1:20

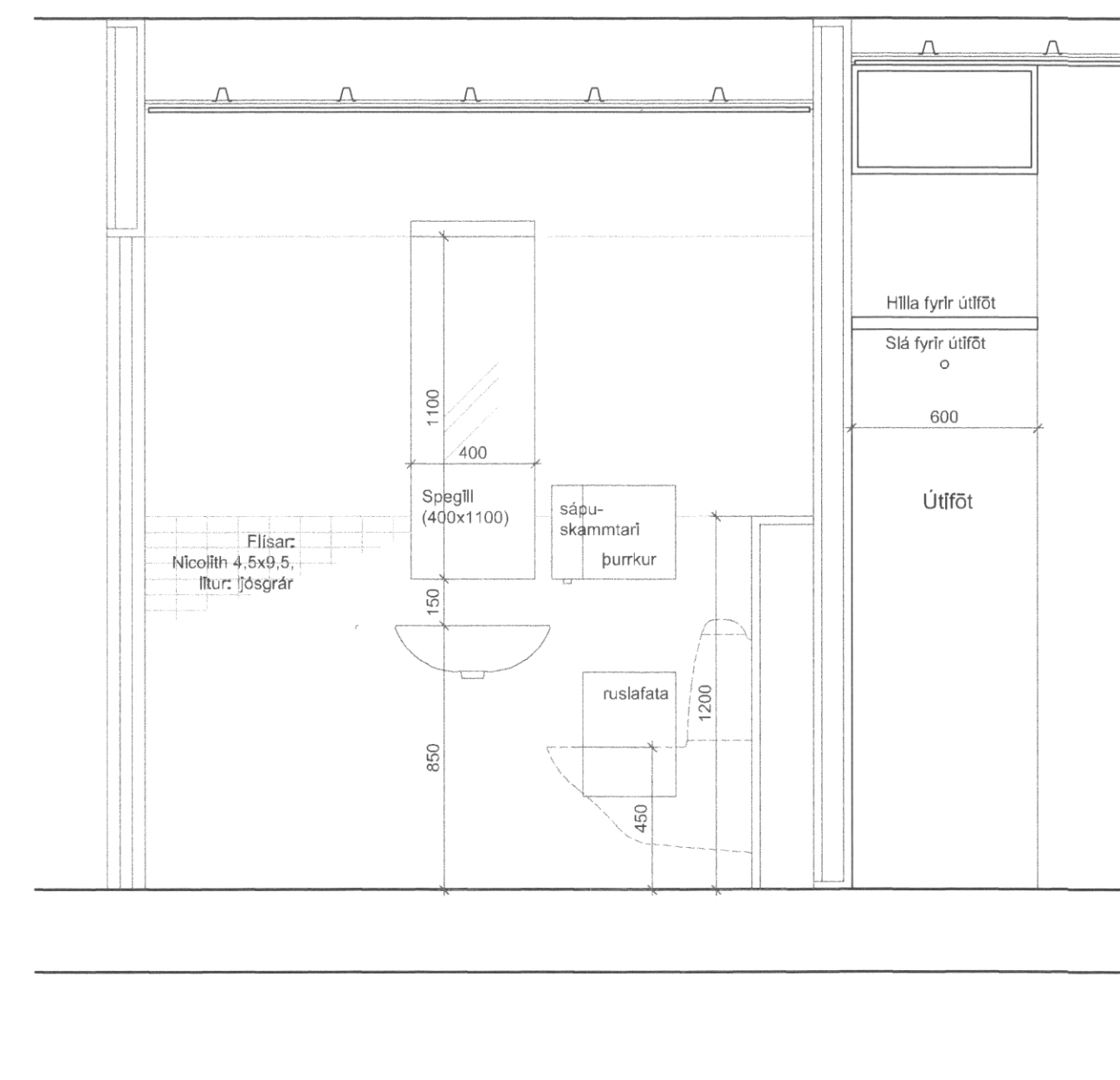

F 70/01 Sneiðing B - B, salerni 1:20

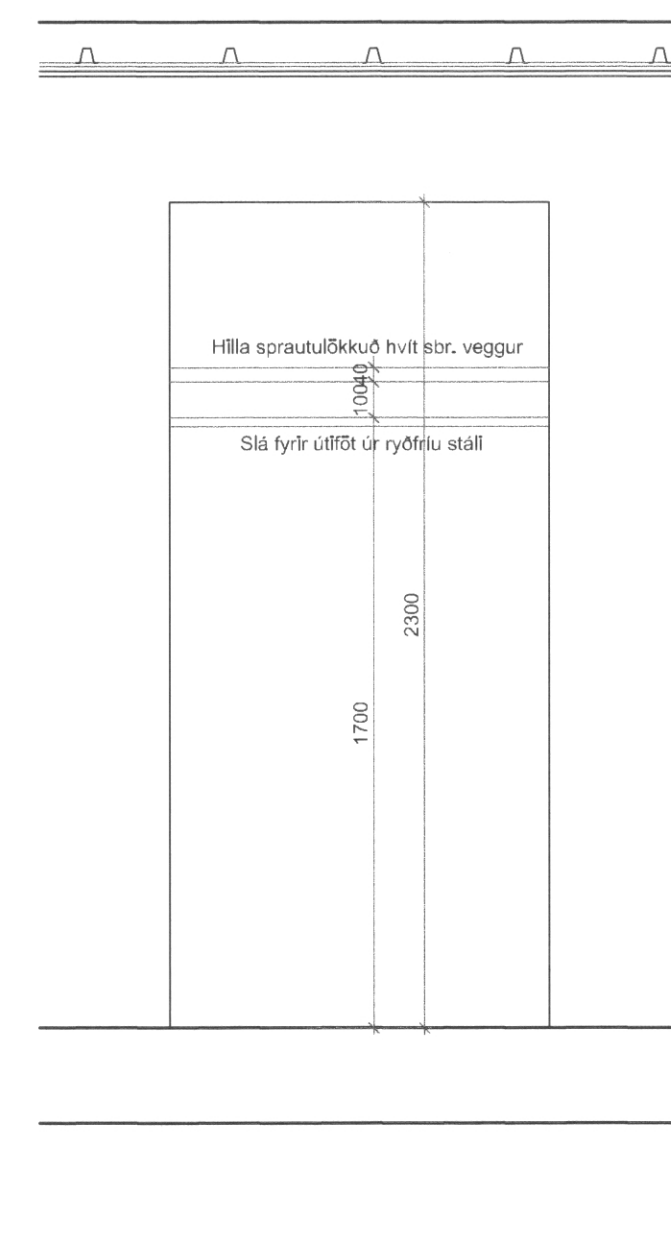

G 70/01 Sneiðing B - B, salerni 1:20

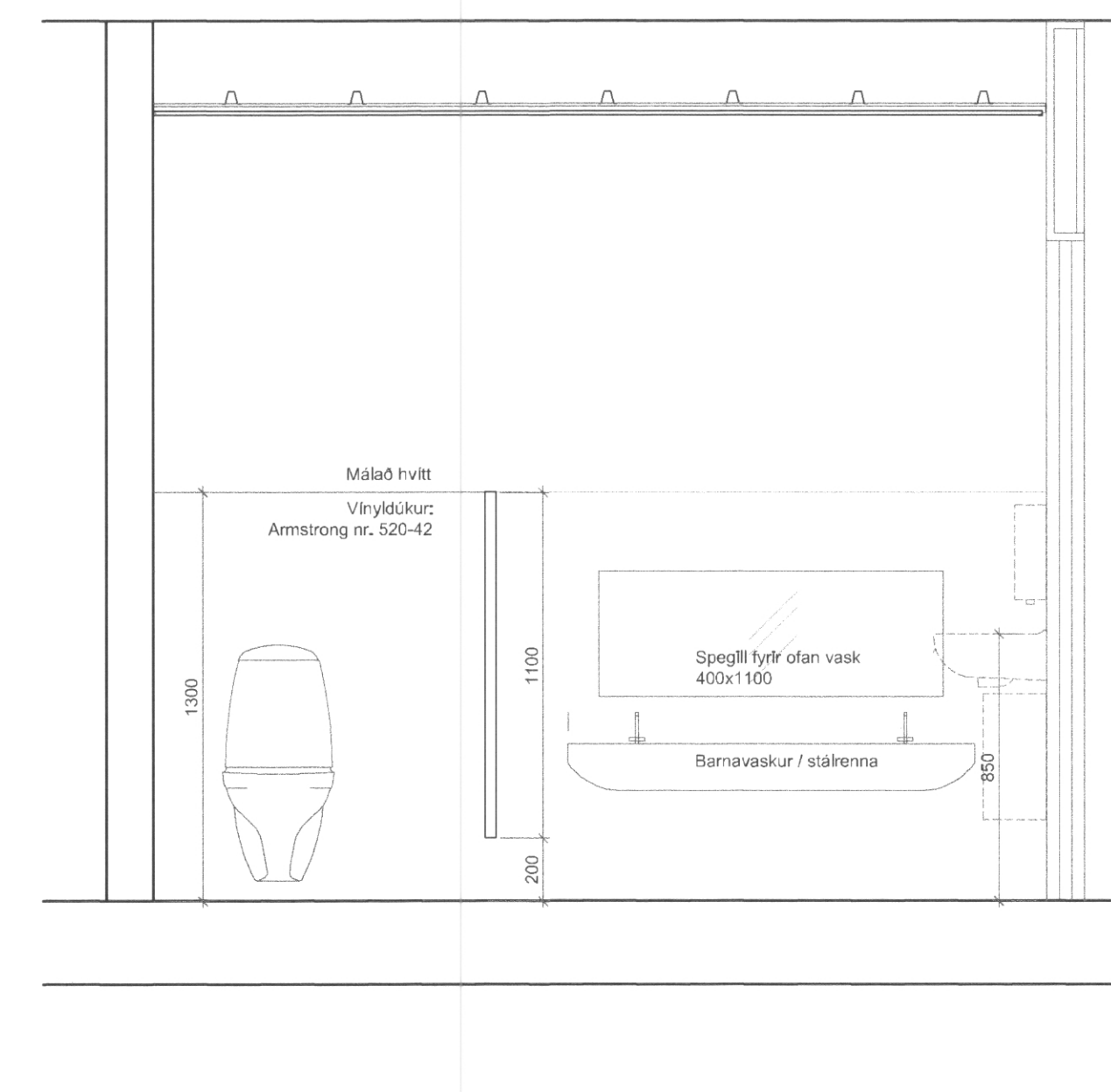

H 70/01 Sneiðing B - B, salerni 1:20

Athugið:
Öll mál og aðstæður athugist á staðnum fyrir smíð.

B2: 14.8.2008 - færsla á stáðsetningu í skipibordum
B1: Nánari skýring á efnisvæðing og breytingar

LEIKSKÓLINN SÓLI, VESTMANNAEYJUM

INNRETTINGAR: MIDHEIMAR
Salerni

28.10.2005 1:20 B2 70-01
Sjg. mál. breyting. teki.

47-44070-239

TEKNIÞYGA HALLDÓRS GUÐMUNDSSONAR FAI
SKULATUN 6 - 105 REYKJAVÍK - Sími: 545 1600
FAX: 545 1616 tvb@tvb.is www.tvb.is

